

260FZ-KZ260

MONORACK SPECIFICO - SPECIFIC MONORACK
MONORACK SPECIFIQUE - SPEZIFISCHES MONORACK - MONORACK ESPECIFICO

HONDA CBF600 '04/'05
HONDA CBF500 '04/'05

ISTRUZIONI DI MONTAGGIO - MOUNTING INSTRUCTIONS
INSTRUCTIONS DE MONTAGE - BAUANLEITUNG - INSTRUCCIONES DE MONTAJE

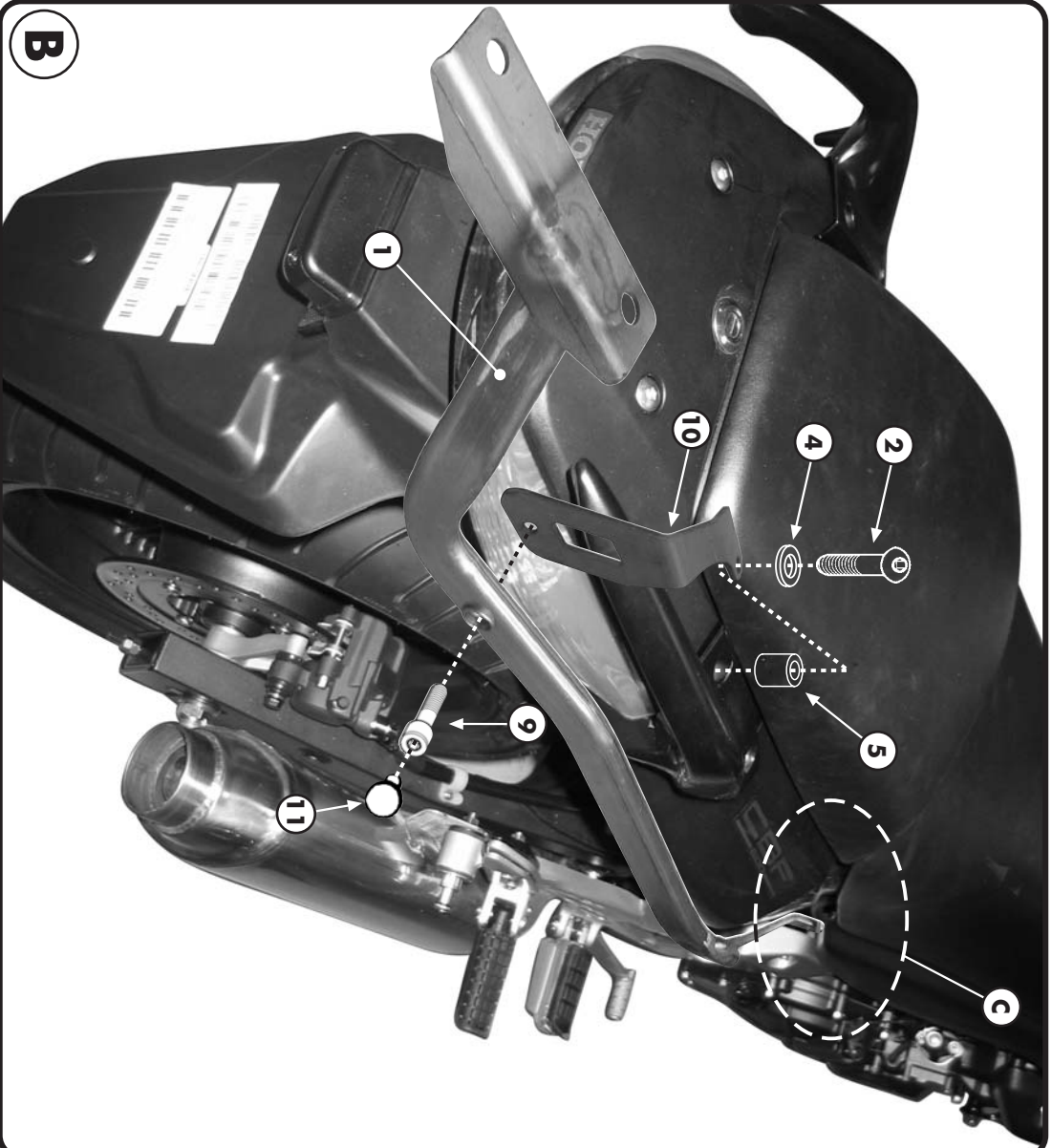
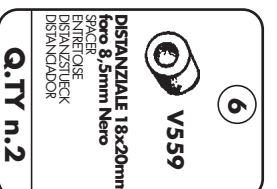
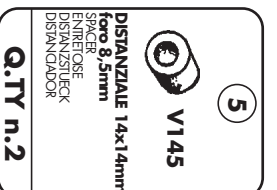
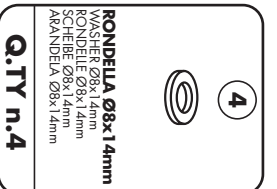
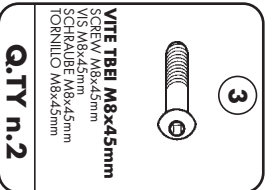
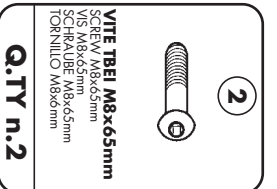
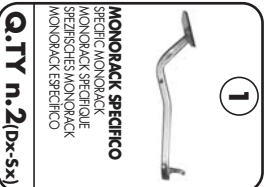

**MONORACK SPECIFICO - SPECIFIC MONORACK
MONORACK SPECIFIQUE - SPEZIFISCHES MONORACK - MONORACK ESPECIFICO**

**HONDA CBF600 '04/'05
HONDA CBF500 '04/'05**

ISTRUZIONI DI MONTAGGIO - MOUNTING INSTRUCTIONS
INSTRUCIONS DE MONTAGE - BAUANLEITUNG - INSTRUCCIONES DE MONTAJE

7
PARTICOLARI INCLUSI NEL KIT VITERIA DELLA PIASTRA
COMPONENTS INCLUDED IN THE FITTING KIT OF THE PLATE
PIECES INCLUSES DANS LE KIT DE VIS DE LA PLATINE
DIE EINZELNEN TEILE SIND BEI MONTAGEKIT DER PLATTE ENTHALTEN
PIEZAS INCLUIDAS EN EL KIT DE TORNERIA DE LA PARRILLA
Q.TY n.-

8
COMPONENTI ORIGINALI
ORIGINAL PARTS
PARTIES BAUTHEILE ORIGINALS
PARTES ORIGINALES
Q.TY n.-

9
VITE TCEI M8x20mm
SCREW M8x20mm
VIS M8x20mm
SCHRAUBE M8x20mm
TORNILLO M8x20mm
Q.TY n.2

10
SUPPORTO
SUPPORT
SUPPORT
HALTERUNG
SOPORTE
Q.TY n.2

11
COPRIVITE Ø8
SCREW CAP
CACHÉ VIS
STOSSSCHRAUBE TAPA TORNILLO
Q.TY n.2

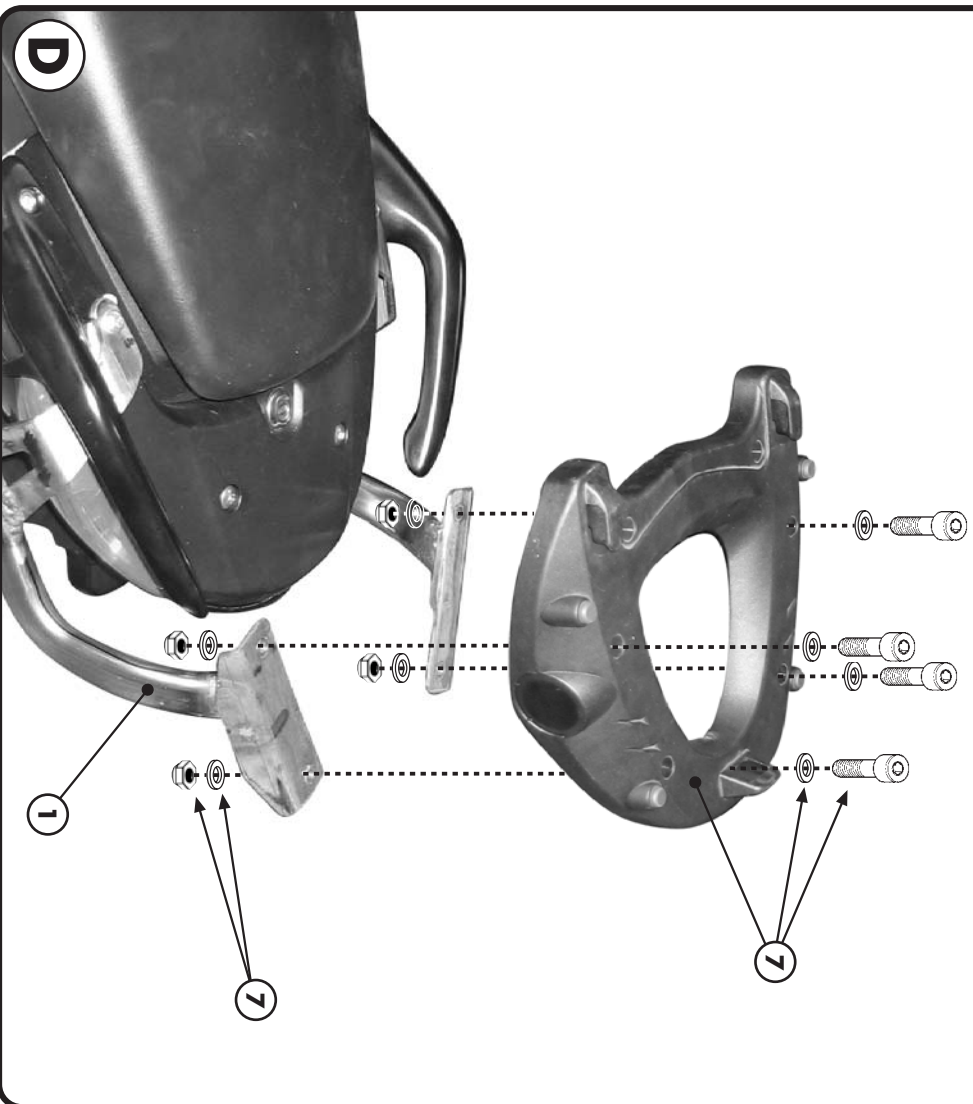
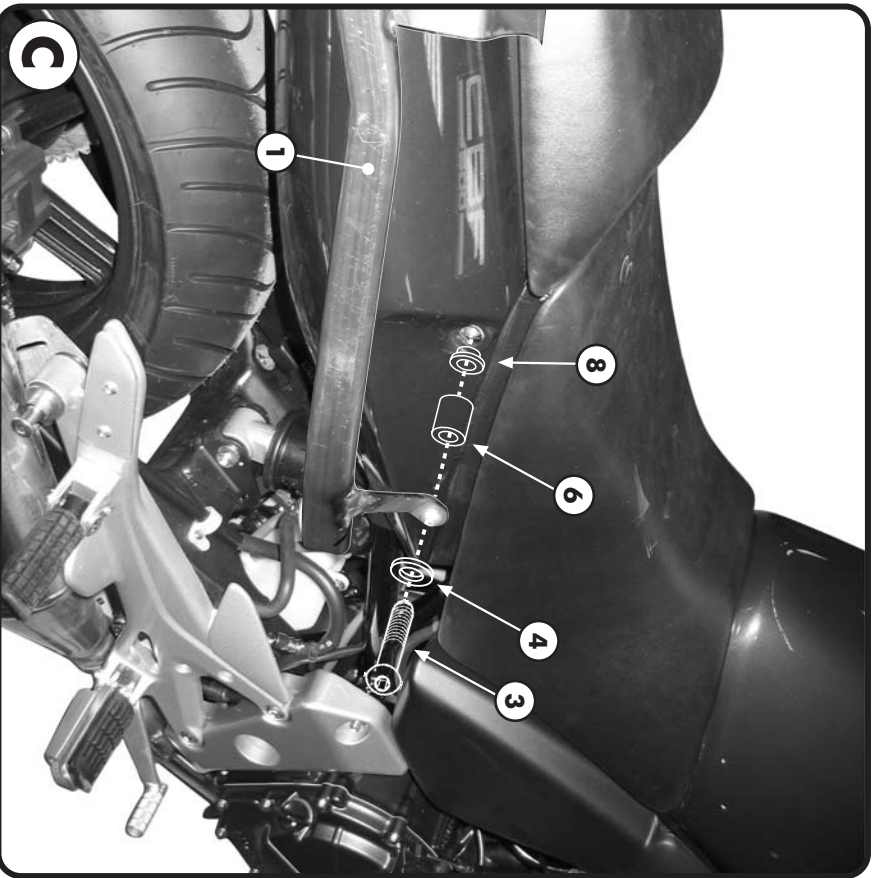

**MONORACK SPECIFICO - SPECIFIC MONORACK
MONORACK SPECIFIQUE - SPEZIFISCHES MONORACK - MONORACK ESPECÍFICO**
**HONDA CBF600 '04/'05
HONDA CBF500 '04/'05**

 ISTRUZIONI DI MONTAGGIO - MOUNTING INSTRUCTIONS
 INSTRUCTIONS DE MONTAGE - BAUANLEITUNG - INSTRUCCIONES DE MONTAJE

I ISTRUZIONI DI MONTAGGIO

1. SMONTARE IL NOTTOLINO ORIGINALE EVIDENZIATO IN FOTO A;
2. POSIZIONARE IL SUPPORTO MONORACK COME INDICATO IN FOTO B;
3. FISSARE LA PARTE ANTERIORE DEL SUPPORTO MONORACK COME INDICATO IN FOTO C;
4. MONTARE LA PIASTRA (NON INCLUSA) COME INDICATO IN FOTO D;
5. ULTIMARE IL MONTAGGIO SERRANDO BENE TUTTE LE VITI.

GB MOUNTING INSTRUCTIONS

1. DEMOUNT THE ORIGINAL MUSHROOM INDICATED IN PICTURE A.
2. PLACE THE MONORACK ARM AS SHOWN IN PICTURE B.
3. FIX THE FRONT PART OF THE MONORACK AS SHOWN IN PICTURE C;
4. MOUNT THE PLATE (SOLD SEPARATELY) AS SHOWN IN PICTURE D.
5. LASTLY TIGHTEN ALL THE SCREWS.

F INSTRUCTIONS DE MONTAGE

1. DEMONTER LES PLOTS D'ORIGINE MIS EN EVIDENCE SUR LA PHOTO A;
2. POSITIONNER LES BRAS DE MONORACK COMME INDIQUE SUR LA PHOTO B;
3. FIXER LA PARTIE AVANT DES SUPPORTS COMME INDIQUE SUR LA PHOTO C;
4. MONTER LA PLATINE (NON INCLUSE) COMME INDIQUE SUR LA PHOTO D;
5. TERMINER LE MONTAGE EN SERRANT BIEN TOUTES LES VIS.

D BAUANLEITUNG

1. NEHMEN SIE DIE ORIGINAL KLINKE AB WIE IM BILD A ABGEBILDET;
2. POSITIONIEREN SIE DAS MONORACK WIE IM BILD B BESCHRIEBEN;
3. BEFESTIGEN SIE DAS VORDERTEIL DES MONORACKS WIE IM BILD C BESCHRIEBEN;
4. MONTIEREN SIE DIE PLATTE (NICHT VORHANDEN - SEPARAT BESTELLEN) WIE IM BILD D BESCHRIEBEN.
5. ZULETZT ZIEHEN SIE ALLE SCHRAUBEN FEST.

ES
INSTRUCCIONES DE MONTAJE

1. DESMONTAR EL REMACHE ORIGINAL INDICADO EN LA FOTO A;
2. MONTAR LOS BRAZOS MONORACK COMO INDICA LA FOTO B;
3. ANCLAR LA PARTE DELANTERA DEL BRAZO MONORACK COMO INDICA LA FOTO C;
4. MONTAR LA PARRILLA (NO INCLUIDA - SE VENDE POR SEPARADO) COMO INDICA LA FOTO D;
5. TERMINAR APRETANDO TODOS LOS TORNILLOS